

A7. 6668 N. Leoti - a Blank Slate Transformed...

*A garden is never finished—
it is a creation that evolves from season-to-season, and year-to-year.
Dedicated gardeners embrace this reality and enjoy the ephemeral nature of their work.*

This new home had only lawn, some birch trees and a few yews lined along the front when the owners bought it just a few years ago. Luckily, they had a vision! They saw potential where most of us would not, and went about transforming their narrow side yard into a lush and comfortable seating area that now offers privacy enclosed in a cozy and beautiful setting. We all watched as they undertook their project.

The transformation occurred in phased layers - beginning with a custom pergola and pavers that established the footprint of their new seating area. To create separation and privacy from the nearby sidewalk, a custom trellis and planter wall were installed. Next, a line of variegated willows and arborvitae were combined with a grouping of hydrangeas to complete the walls that established the enclosure for their new space. A mix of furniture and accessories from a variety of local stores created an inviting outdoor patio for reading and visiting with neighbors. Plants adorn the many pots and planters scattered through this area, with the wall planter overflowing with a mix of coleus plants, all combining to provide intense colors, textures, and interest to this enchantingly comfortable enclosure.

Next, small shrubs including elderberry and Japanese Pieris, as well as decorative pots and metal works combined to create a detailed garden, designed to draw your attention. These smaller plantings stretched

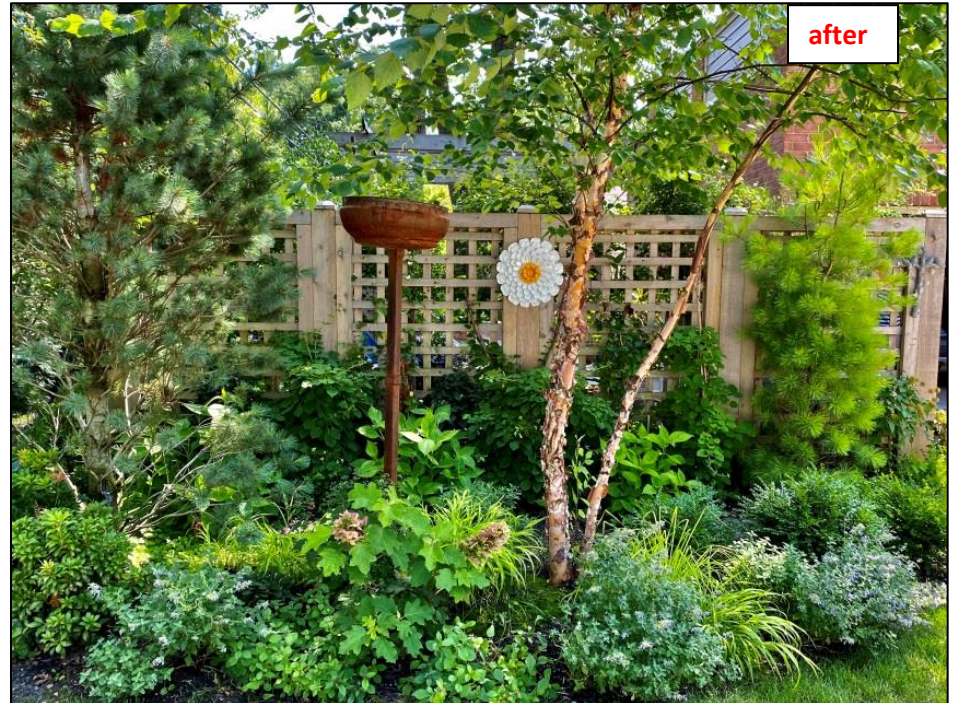

around the perimeter of the new seating area and along the entire front of the home, wrapping the house in a beautiful tapestry of color. Eventually metal artwork and wall decorations made the setting complete.



Along the front of the home, interesting plant combinations, where conifers blend with birch trees, lilacs, hydrangeas, Japanese maples and perennials, creating a colorful range of foliage that delivers a dramatic display throughout the season.

This home exemplifies the impact a gardener's attention to detail can have. In her hands, this masterpiece is always evolving.

It is truly her passion, and it clearly shows!

